



FITTING INSTRUCTIONS FOR CP0459 CRASH PROTECTORS
KAWASAKI VERSYS 1000 2019 -



THIS KIT CONTAINS THE ITEMS PICTURED AND LABELLED BELOW.
DO NOT PROCEED UNTIL YOU ARE SURE ALL PARTS ARE PRESENT.

Please note that the way the kit is packed does not necessarily represent the way of mounting to the bike.

Please note that in cases where kits are packed with rubber washers holding the components onto the bolt – *the rubber washers should be thrown away!*

THE PARTS SHOWN MAY BE REPRESENTATIVE ONLY (FOR CLARITY OF INSTRUCTIONS ONLY).

Digital copies of these instructions are available to download from www.rg-racing.com

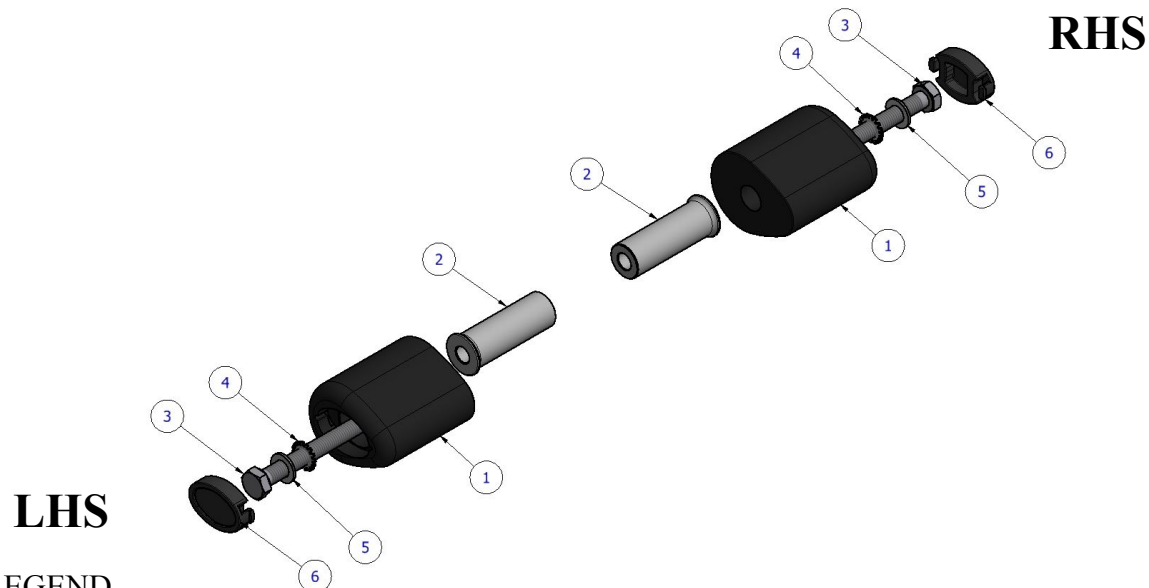
**LEGEND**

- ITEM 1 = CRASH PROTECTOR (BO061 with CS341) (x2)
 ITEM 2 = SPACER LHS & RHS 63mm LONG (S1166) (x2)
 ITEM 3 = M10 x 1.25 x 140mm LONG HEX HEAD BOLT (x2)
 ITEM 4 = LOCK WASHER (LW0001) (x2)
 ITEM 5 = M10 WASHER (x2)
 ITEM 6 = CRASH PROTECTOR CAP (BC0002) (x2)

TOOLS REQUIRED

- Socket set to include 14mm A/F & 17mm socket and wrench.

MAXIMUM TORQUE SETTINGS

- M4 BOLT = 8Nm
 M5 BOLT = 12Nm
 M6 BOLT = 15Nm
 M8 BOLT = 20Nm
 M10 BOLT = 40Nm

R&G

Unit 1, Shelley's Lane, East Worldham, Alton, Hampshire, GU34 3AQ
 Tel: +44 (0)1420 89007 Fax: +44 (0)1420 87301 www.rg-racing.com Email: info@rg-racing.com

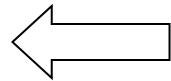

REAR OF BIKE

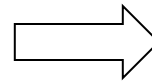
PICTURE A

FRONT OF BIKE

FITTING INSTRUCTIONS

- Using a 14mm socket and wrench, remove the engine bolt arrowed above.
- Slide an M10 WASHER (ITEM 5) over the M10 x 140mm BOLT (ITEM 3), followed by a LOCK WASHER (ITEM 4), so the washers sit against the head of the bolt.
- Next slide the bolt with washers through either crash protector (ITEM 1) so the head of the bolt and washers goes into the counter-bore in the bobbin.
- Slide one of the spacers over the exposed thread, so the flanged end of the spacer sits against the bobbin.
- Offer the crash protector assembly up to the frame mount and begin to tighten the bolt as shown above.
- Tighten the bolt until you feel some compression from inside the protector using 17mm socket and wrench. **PLEASE NOTE THE CRASH PROTECTOR MUST BE POSITIONED AS IN PICTURE 'A' WITH BIGGER END TOWARD FRONT OF BIKE.** Turn a little more so that you feel the compression increase slightly. Then apply a quarter turn. Do not over tighten as damage can occur to the bike. Do not exceed 40nm of torque.
- Repeat the above steps for the other side.
- If not already fitted fit bubble stickers into recess of both crash protector caps.
- Fit crash protector caps into both crash protectors.

ISSUE 23/01/2019 (LF)

CONSUMER NOTICE

The catalogue description and any exhibition of samples are only broad indications of the Products and R&G may make design changes which do not diminish their performance or visual appeal and supplying them in such state shall conform to the order. The Buyer acknowledges no representation or warranty (other than as to title) has been given or will apply to the Products other than those in R&G's order or confirmation and the Buyer confirms it has chosen the Products as being of merchantable quality and suitable for its particular purposes. Where R&G fits the Products or undertakes other services it shall exercise reasonable skill and care and rectify any fault free of charge unless the workmanship has been disturbed. The Buyer is responsible for ensuring that the warranty on the motorcycle is not affected by the fitting of the Products. On return of any defective Products R&G shall at its option either supply a replacement or refund the purchase money but shall not be liable if the Products have been modified or used or maintained otherwise than in accordance with R&G's or manufacturer's instructions and good engineering practice or if the defect arises from accident or neglect. Other than identified above and subject to R&G not limiting its liability for causing death and personal injury, it shall not be liable for indirect or consequential loss and otherwise its liability shall be limited to the amounts paid by the Buyer for the Products or the fitting or service concerned. These terms do not affect the Buyer's statutory rights.

R&G RETURNS POLICY (NON-FAULTY GOODS)

Returns must be pre-authorized (if not pre-authorized the return will be rejected). Goods may only be returned direct to us if they were purchased direct from us (customer must prove if necessary). Otherwise to be returned to original vendor. Goods must be in re-sellable condition, in the opinion of R&G. All returns are subject to a 25% restocking and handling fee (25% of the gross value exc. P&P – at the prevailing price at time of purchase). The customer must pay any and all carriage charges. No returns of discontinued products, unless within 14 days of purchase. This policy does not affect your statutory rights and does not refer to faulty goods.

R&G

Unit 1, Shelley's Lane, East Worldham, Alton, Hampshire, GU34 3AQ

Tel: +44 (0)1420 89007 Fax: +44 (0)1420 87301 www.rg-racing.com Email: info@rg-racing.com



NOTICE DE MONTAGE CP0459 PROTECTIONS CRASH
KAWASAKI VERSYS 1000 2019 -



Le kit contient les articles exposés ci-dessous, vérifier que toutes les pièces soient présentes avant de procéder au montage.

La façon dont le kit est emballé ne correspond pas forcément à la façon de monter les pièces sur la moto.

Notez que si les kits sont emballés avec des rondelles en caoutchouc servant à tenir les composants, *ces rondelles doivent être jetées*

LES PARTIES PRÉSENTÉES PEUVENT ÊTRE UNIQUEMENT REPRESENTATIVES (POUR LA CLARTE DES INSTRUCTIONS UNIQUEMENT.

Digital copies of these instructions are available to download from www.rg-racing.com

R&G
Unit 1, Shelley's Lane, East Worldham, Alton, Hampshire, GU34 3AQ
Tel: +44 (0)1420 89007 Fax: +44 (0)1420 87301 www.rg-racing.com Email: info@rg-racing.com

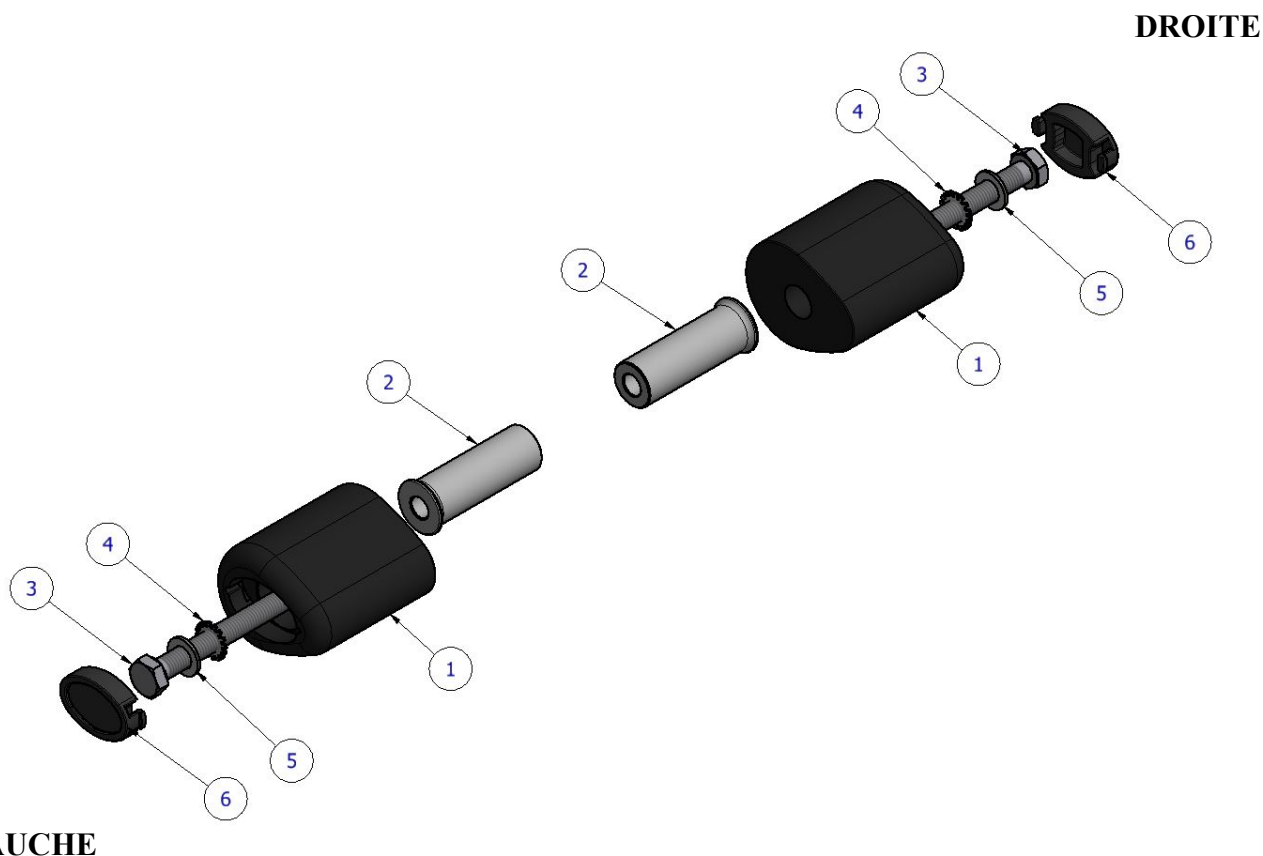
**GAUCHE****DROITE****LÉGENDE**

- ARTICLE 1 = PROTECTION CRASH (BO061 avec CS341) (x2)
 ARTICLE 2 = ENTRETOISE GAUCHE ET DROITE 63mm de long (S1166) (x2)
 ARTICLE 3 = M10 x 1.25 x 140mm BOULON (x2)
 ARTICLE 4 = RONDELLE DE BLOCAGE (LW0001) (x2)
 ARTICLE 5 = M10 RONDELLE (x2)
 ARTICLE 6 = BOUCHON DE PROTECTION CRASH (BC0002) (x2)

OUTILS REQUIS

- Clé à cliquet + douille 14mm & 17mm

VALEUR DE SERRAGE RECOMMANDÉE

M4 BOULON = 8Nm
 M5 BOULON = 12Nm
 M6 BOULON = 15Nm
 M8 BOULON = 20Nm
 M10 BOULON = 40Nm

R&G

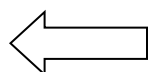

ARRIÈRE MOTO

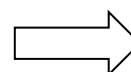

AVANT MOTO

PHOTO A**NOTICE DE MONTAGE**

- Utiliser une clé à cliquet + douille de 14mm, enlever le boulon moteur indiqué ci-dessus.
- Glisser une rondelle M10 (ARTICLE 5) sur le boulon M10 x 140mm (ARTICLE 3), suivi d'une rondelle de blocage (ARTICLE 4), de façon à ce que les rondelles se placent contre la tête du boulon.
- Glisser ensuite le boulon avec ses rondelles dans la protection crash (ARTICLE 1) de façon à ce que la tête du boulon et les rondelles se placent dans le contre alésage de la bobine.
- Glisser une des entretoises sur l'extrémité du filetage, de façon à ce que l'extrémité bridée de l'entretoise se place contre la bobine.
- Monter la protection sur le support de cadre puis commencer à serrer le boulon, voir ci-dessus.
- Serrer le boulon jusqu'à ce que vous sentiez une légère compression à l'intérieur de la protection, en utilisant une clé à cliquet de 17mm. **LA PROTECTION DOIT ETRE POSITIONNEE AVEC LE CÔTÉ ARRONDI LE PLUS GROS EN DIRECTION DE L'AVANT DE LA MOTO.** Tourner un peu plus afin d'accroître légèrement la compression. Faire un quart de tour. Serrer à 40Nm de couple (Ne pas excéder cette valeur, car cela pourrait endommager la moto et le boulon).
- Répéter les précédentes étapes pour l'autre côté.
- Si cela n'est pas déjà fait, insérer les stickers dans le creux des 2 bouchons de protections crash.
- Insérer les bouchons de protection crash dans les 2 protections

ISSUE 23/01/2019 (LF)

CONSUMER NOTICE

The catalogue description and any exhibition of samples are only broad indications of the Products and R&G may make design changes which do not diminish their performance or visual appeal and supplying them in such state shall conform to the order. The Buyer acknowledges no representation or warranty (other than as to title) has been given or will apply to the Products other than those in R&G's order or confirmation and the Buyer confirms it has chosen the Products as being of merchantable quality and suitable for its particular purposes. Where R&G fits the Products or undertakes other services it shall exercise reasonable skill and care and rectify any fault free of charge unless the workmanship has been disturbed. The Buyer is responsible for ensuring that the warranty on the motorcycle is not affected by the fitting of the Products. On return of any defective Products R&G shall at its option either supply a replacement or refund the purchase money but shall not be liable if the Products have been modified or used or maintained otherwise than in accordance with R&G's or manufacturer's instructions and good engineering practice or if the defect arises from accident or neglect. Other than identified above and subject to R&G not limiting its liability for causing death and personal injury, it shall not be liable for indirect or consequential loss and otherwise its liability shall be limited to the amounts paid by the Buyer for the Products or the fitting or service concerned. These terms do not affect the Buyer's statutory rights.

R&G RETURNS POLICY (NON-FAULTY GOODS)

Returns must be pre-authorized (if not pre-authorized the return will be rejected). Goods may only be returned direct to us if they were purchased direct from us (customer must prove if necessary). Otherwise to be returned to original vendor. Goods must be in re-sellable condition, in the opinion of R&G. All returns are subject to a 25% restocking and handling fee (25% of the gross value exc. P&P – at the prevailing price at time of purchase). The customer must pay any and all carriage charges. No returns of discontinued products, unless within 14 days of purchase. This policy does not affect your statutory rights and does not refer to faulty goods.

R&G

Unit 1, Shelley's Lane, East Worldham, Alton, Hampshire, GU34 3AQ

Tel: +44 (0)1420 89007 Fax: +44 (0)1420 87301 www.rg-racing.com Email: info@rg-racing.com



MONTAGEANLEITUNG FÜR CP0459 STURZPADS
KAWASAKI VERSYS 1000 2019 -



ALLE KIT-TEILE SIND UNTEN ABGEBILDET UND GEKENNZEICHNET. ÜBERPRÜFEN SIE, DASS ALLE TEILE VORHANDEN SIND, BEVOR SIE MIT DER MONTAGE BEGINNEN.

Hinweis: Die Verpackung der Teile stellt nicht die Reihenfolge der Montage dar.

Hinweis für Kits mit Plastikunterlegscheiben an den Schrauben – *Diese Plastikunterlegscheiben werden nicht für den Einbau benötigt!*

DIE UNTEN ABGEBILDETEN TEILE DIENEN LEDIGLICH ZUR ERKLÄRUNG

Eine digitale Version dieser Montageanleitung kann auf folgender Seite heruntergeladen werden:
www.rg-racing.com

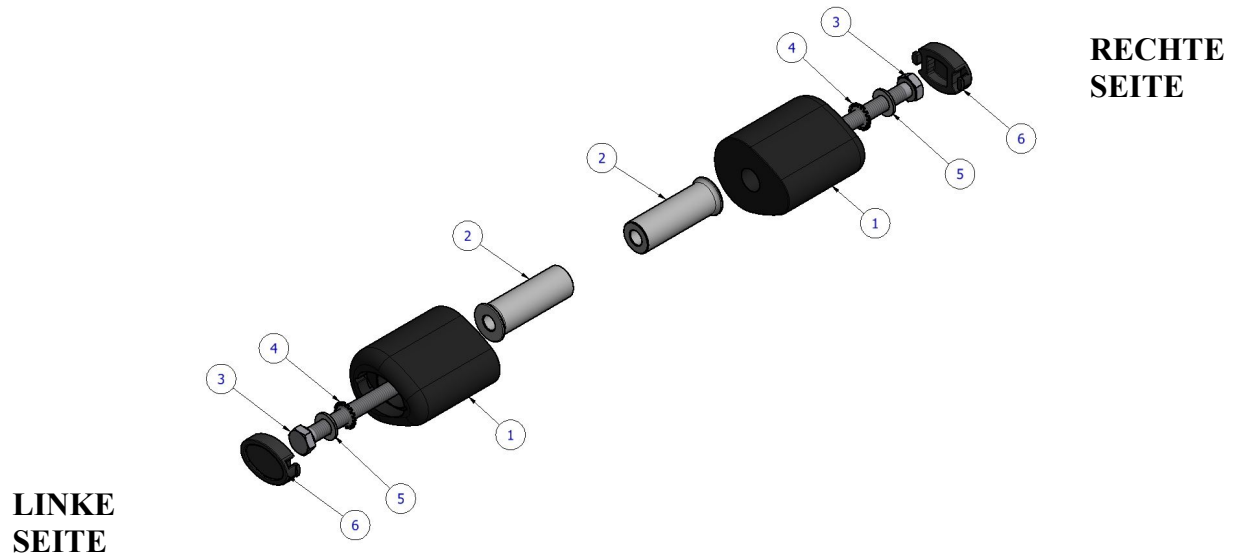

LIEFERUMFANG

- ARTIKEL 1 = STURZPAD (BO061 mit CS341) (x2)
- ARTIKEL 2 = DISTANZHALTER RECHTE UND LINKE SEITE 63mm Länge (S1166) (x2)
- ARTIKEL 3 = M10 x 1,25 x 140mm SECHSKANTSCHRAUBE (x2)
- ARTIKEL 4 = ZAHNSCHEIBE (LW0001) (x2)
- ARTIKEL 5 = M10 UNTERLEGSCHIEBE (x2)
- ARTIKEL 6 = SCHUTZKAPPE (BC0002) (x2)

SIE BENÖTIGEN FOLGENDES

- Steckschlüsselsatz mit 14mm A/F & 17mm Steckschlüssel

MAX. ANZUGSDREHMOMENT

- M4 SCHRAUBE = 8Nm
- M5 SCHRAUBE = 12Nm
- M6 SCHRAUBE = 15Nm
- M8 SCHRAUBE = 20Nm
- M10 SCHRAUBE = 40Nm



ABBILDUNG A



MONTAGEANLEITUNG

- Mit einem 14mm Steckschlüssel die Schraube für den Motor entfernen, die oben gekennzeichnet ist.
- Nehmen Sie eine M10 x 140mm Schraube (Artikel 3) und eine M10 Unterlegscheibe (Artikel 5). Scheiben Sie die Unterlegscheibe hoch bis zum Schraubenkopf. Eine Zahnscheibe (Artikel 4) nehmen und zur gerade montierten Unterlegscheibe hochschieben.
- Die Schraube mit den Unterlegscheiben in ein Sturzpad (Artikel 1) einführen, so dass der Schraubenkopf und die Unterlegscheiben in die Vertiefung des Sturzpads passen.
- Einen Distanzhalter über das hervorstehende Gewinde schieben, sodass er am Sturzpad anliegt.
- Die Einheit an die Rahmenhalterung ansetzen und die Schraube anziehen wie oben abgebildet.
- Ziehen Sie die Schraube mit einem 17 mm Steckschlüssel fest, bis Sie etwas Druck vom Inneren des Sturzpads spüren. **BITTE DARAUFG ACHTEN, DASS DAS STURZPAD WIE IN ABBILDUNG 'A' POSITIONIERT IST – DAS GRÖßERE ENDE DES STURZPADS ZUM VORDERTEIL DES MOTORRADS GERICHTET.** Noch etwas drehen, bis Sie merken, dass der Druck sich leicht erhöht, dann noch eine Vierteldrehung anwenden. Nicht überdrehen – dies kann zu einer Beschädigung des Motorrades führen. 40 Nm Anzugsmoment nicht überschreiten
- Wiederholen Sie diese Schritte an der anderen Seite des Motorrades.
- Wenn noch nicht bereits montiert, montieren Sie die Bubble-Aufkleber in der Vertiefung der Sturzpad-Schutzkappen.
- Die Schutzkappen an den Sturzpads montieren.

AUSGABE 23/01/2019 (LF)

CONSUMER NOTICE

The catalogue description and any exhibition of samples are only broad indications of the Products and R&G may make design changes which do not diminish their performance or visual appeal and supplying them in such state shall conform to the order. The Buyer acknowledges no representation or warranty (other than as to title) has been given or will apply to the Products other than those in R&G's order or confirmation and the Buyer confirms it has chosen the Products as being of merchantable quality and suitable for its particular purposes. Where R&G fits the Products or undertakes other services it shall exercise reasonable skill and care and rectify any fault free of charge unless the workmanship has been disturbed. The Buyer is responsible for ensuring that the warranty on the motorcycle is not affected by the fitting of the Products. On return of any defective Products R&G shall at its option either supply a replacement or refund the purchase money but shall not be liable if the Products have been modified or used or maintained otherwise than in accordance with R&G's or manufacturer's instructions and good engineering practice or if the defect arises from accident or neglect. Other than identified above and subject to R&G not limiting its liability for causing death and personal injury, it shall not be liable for indirect or consequential loss and otherwise its liability shall be limited to the amounts paid by the Buyer for the Products or the fitting or service concerned. These terms do not affect the Buyer's statutory rights.

R&G RETURNS POLICY (NON-FAULTY GOODS)

Returns must be pre-authorized (if not pre-authorized the return will be rejected). Goods may only be returned direct to us if they were purchased direct from us (customer must prove if necessary). Otherwise to be returned to original vendor. Goods must be in re-sellable condition, in the opinion of R&G. All returns are subject to a 25% restocking and handling fee (25% of the gross value exc. P&P – at the prevailing price at time of purchase). The customer must pay any and all carriage charges. No returns of discontinued products, unless within 14 days of purchase. This policy does not affect your statutory rights and does not refer to faulty goods.

R&G

Unit 1, Shelley's Lane, East Worldham, Alton, Hampshire, GU34 3AQ

Tel: +44 (0)1420 89007 Fax: +44 (0)1420 87301 www.rg-racing.com Email: info@rg-racing.com